

INCLINED CONVEYOR SEPARATOR

ST1 ST3

ST1

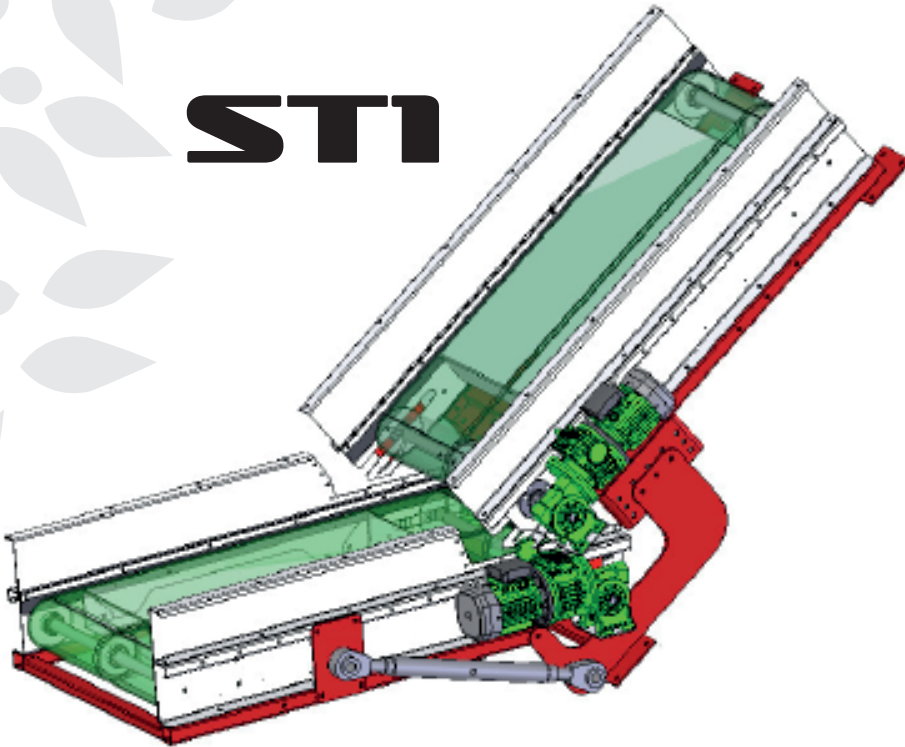

ST3

Manufacturer of solutions for the harvest and work of the fruits 

A M B R o u s s e t
impasse du Tilleul
38470 BEAULIEU - France



Tél : +33 (0) 4 76 36 73 73
Fax : +33 (0) 4 76 36 70 82
E-mail : export@ambrousset.com
www.amb-rousset.com

INCLINED CONVEYOR SEPARATOR

ST1 ST3

Technical features

This wood and sticks conveyor allow to separate the impurity from the fine product (walnuts, hazelnuts, almonds, cider apples...) thanks to a input conveyor and a inclined conveyor.

The speed variator of the feeding belt allows to adjust the speed of the product to be separated.

The variable speed drive and the angle of the inclined belt allow you to adjust the separation.

The raw product falls on the inclined belt, then the noble product goes to the front and the waste goes to the back of the belt.

This machine is a separation system that can be installed in your facility before or after your washers

	ST1	ST2	ST3
Moteur	2 X 0,37 Kw	3 X 0,37 Kw	4 X 0,37 Kw
Variateur de vitesse	Mécanique sur chaque moteur		
Débit	Environ 800 kg/h (selon le modèle choisi c'est la qualité du triage qui va changer)		
Poids sans tapis ameneur	35 kg	100 kg	130 kg
Poids avec tapis ameneur	100 kg	130 kg	170 kg
Longueur	1,1 m	1,99 m	2,19 m
Largeur hors tout	0,96 m	0,94 m	0,88 m
Largeur du tapis	0,59 m	0,50 m	0,50 m
Hauteur	1,02 m	1,58 m	1,58 m

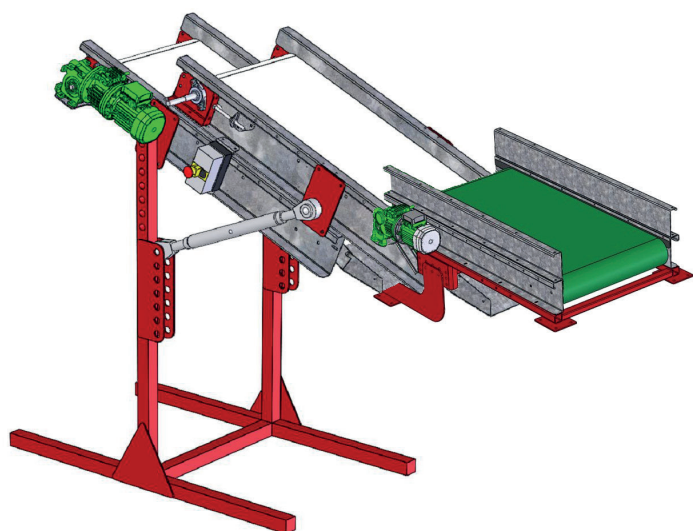

ST2

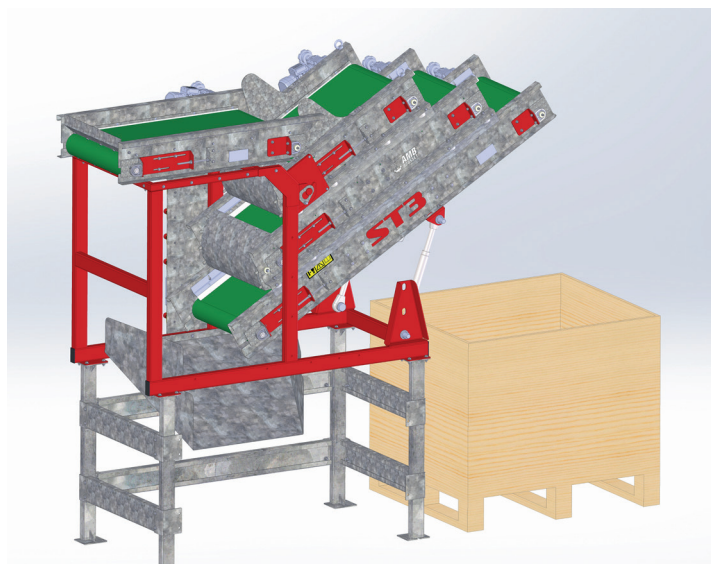

ST3